

How to log into Canvas: STUDENTS

TO ACCESS CANVAS FOLLOW THESE STEPS

- Go to <http://southerncross.instructure.com>
- OR use link from [Southern Cross School of Distance Education](#) website
- OR Google “southern cross distance education” and our webpage is first on search list.
- On the website choose from the top line menu the ‘Online Lesson’ tab and you will find a tab for Canvas, and on the first line of writing a link to [Canvas](#), and also a pdf ‘How to login to Canvas’.
- Select Student login on the “Discovery page”

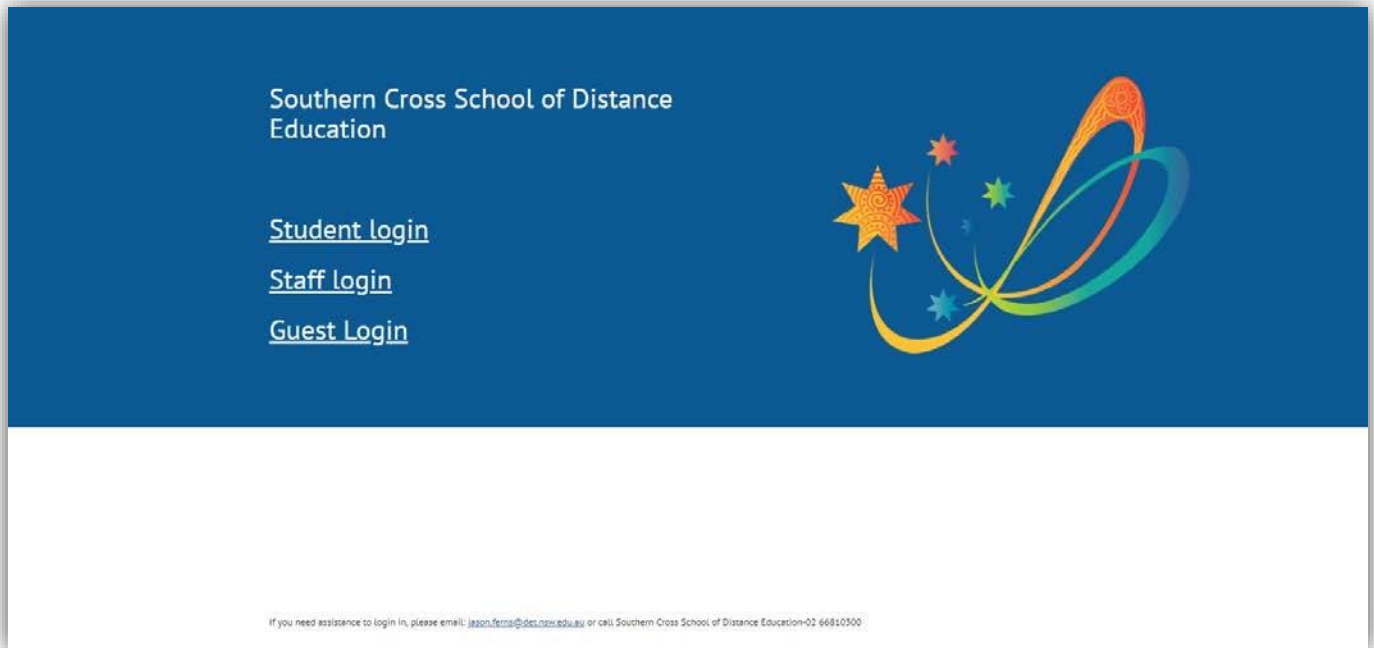

- Students will then authenticate using a Microsoft sign in page.

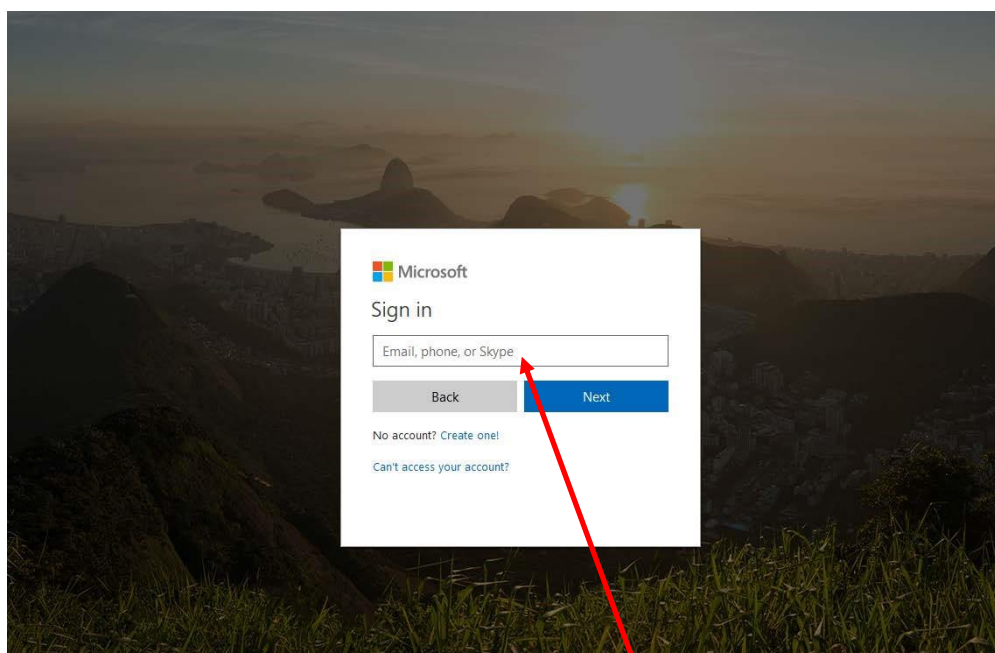

Students need to enter their full email address: e.g. john.smith@education.nsw.gov.au

NOTE: If you have already signed into Canvas previously or your Office 365 account, you will see your email, so select this and you will not need to do the next step of signing into the portal again.



Canvas

Which account do you want to use?



Smith, John
john.smith@education.nsw.gov.au
Signed in



Use another account

- Finally, students will then be redirected to the Department of Education portal login page and will use their portal User ID and password. The User ID is your email address minus the @education.nsw.gov.au: (e.g. john.smith) and your password.

Log in with your DoE account

User ID

Example: jane.citizen1

Password

[Forgot your password?](#)

[Log in](#)

- If you have forgotten or do not know your password please contact your teacher as all staff at Southern Cross SODE have the ability to reset student passwords. You may also ring the technology help desk on 02 6681 0424.

WHO USES THE GUEST LOGIN?

- The Guest login will be used by students who have having issues with their portal password
- Students who for some other reason cannot access Canvas via the normal method.
- If using the guest login you will be allocated a new username and password.